

# P5 Ugelli a fessure verticali

## Filter nozzles with vertical slots

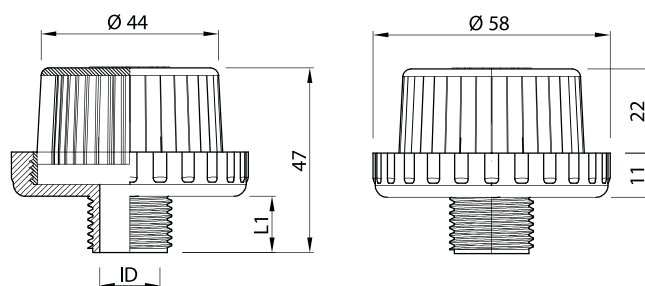

NOZZLE P5 - ID10

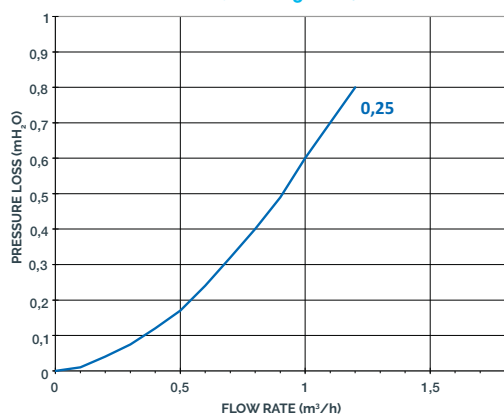

- Adatto per distributori di scambiatori a resine e letti misti
- Adatto per il montaggio su raccordi filettati commerciali
- Economico

- Suitable for resin's ion exchangers and mixed beds
- Suitable for installation on commercial threaded fittings
- Inexpensive

### Materiale

Material

ABS

PP

PPFV

PVDF

| Modello<br>Model | Fessura<br>Slot width<br>mm | N' Fessure<br>Slots n' | Area<br>mm <sup>2</sup> | Colore<br>Colour |
|------------------|-----------------------------|------------------------|-------------------------|------------------|
| P5               | 0,25                        | 36                     | 180                     |                  |

Ugello con certificazione ACS/MOCA prodotto PP Naturale (Bianco) - Ugello in PPFV30% prodotto Naturale (Aorio) - Ugello in ABS e PVDF prodotto Naturale (Bianco)  
Nozzle with ACS/MOCA certification produced PP Natural (White) - Nozzle in PPFV30% produced Natural (Ivory) - Nozzle in ABS and PVDF produced Natural (White)

| Filetto<br>Thread | Col. codolo<br>Stem col. | ID<br>Standard<br>mm | Area codolo<br>Stem area<br>mm <sup>2</sup> | L1 - Lunghezza filetto<br>Thread length<br>mm |
|-------------------|--------------------------|----------------------|---|---|
|                   |                          |                      |   |   |
| 1/2" G            |                          | 15                   | 176   | 14  |
| 3/4" G            |                          | 15                   | 176   | 14  |
| 7/8" W            |                          | 15                   | 176   | 14  |

### ORDINE - ORDER

| Modello<br>Model | Fessura<br>Slot width | Filetto<br>Thread | ID<br>mm | L1<br>mm | L2<br>mm | L3<br>mm | Materiale<br>Material |
|------------------|-----------------------|-------------------|----------|----------|----------|----------|-----------------------|
| P5               | 0,25                  | 3/4" G            | 15       | 14       | 14       | 0        | PP                    |