

FOLDING DOOR INFO

Determining a folding door system and parts

The installation space & environment

The installation environment determines which materials should be used (e.g. Al, Fe or AISI) and how to install the system

Folding method & direction

The opening method and space requirements determines if an endfold or centrefold system should be specified. Folding door systems are folded typically one sided or as bi-parting. Floating units and entrance doors can be also specified.

Door size, construction & weight

The opening's width affects the number of door leaves while the thickness, width, height and weight per leaf determines the product Series to be used.

1. Choose the **SERIES** according to your needs:

Environment / Application examples	Max. door leaf weight (2 wheel hanger)	Max. door leaf weight (4 wheel hanger)	Max. recommended leaf dimensions	SERIES
Interior use Apartments and commercial spaces.	-	25 kg	h: 2000 mm w: 600 mm	75 (902/904)
Interior / Exterior use Commercial and industrial environments.	30 kg	50 kg	h: 2750 mm w 900 mm	100
	50 kg	75 kg	h: 3000 mm w 1000 mm	150
	75 kg	100 kg	h: 3500 mm w 1000 mm	300
	100 kg	150 kg	h: 4500 mm w 1000 mm	500

2. Choose an **ENDFOLD** or a **CENTREFOLD** system:

Endfold installation example. Uses pivot set (to allow the same width to all leaves) or hinges.

(● = Sliding hanger)

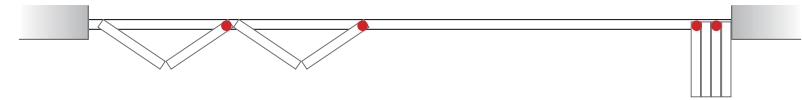

Centrefold installation example. Uses only hinges.

(● = Sliding hanger)

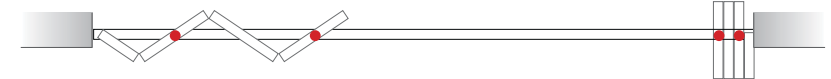

3. Choose the **COMPONENTS** as follows:

1 Track:

Track length is normally the width of the door opening.

2 Hangers and plates:

There are two different types of hangers: Endfold and centrefold hangers. Use one hanger per every second door leaf. Use 2-wheel hangers whenever possible (pay attention to the kg). With an uneven number of leaves the hanger closest to the swing leaf should be a 4-wheel hanger. The type of plate depends on whether the system is endfold or centrefold.

3 Pivot sets:

Pivot sets can be used only with an endfold system. If pivot sets are used, then all the door leaves can be the same width.

4 Brackets:

You can choose between wall or soffit brackets.
Number of brackets = Length of track (m) + 1 pcs, an extra bracket should be installed approximately 0,3 m from the end bracket where the door leaves stack.
Brackets are installed at a maximum of 1 metre intervals.
With series 75 the track can also be fixed directly to the ceiling.

5 Bottom guide:

A bottom guide ensures faultless and safe operation of the door and also prevents the door from swinging. A bottom guide should be installed on every second leaf. The bottom guide plate depends on if the system is an endfold or a centrefold system.

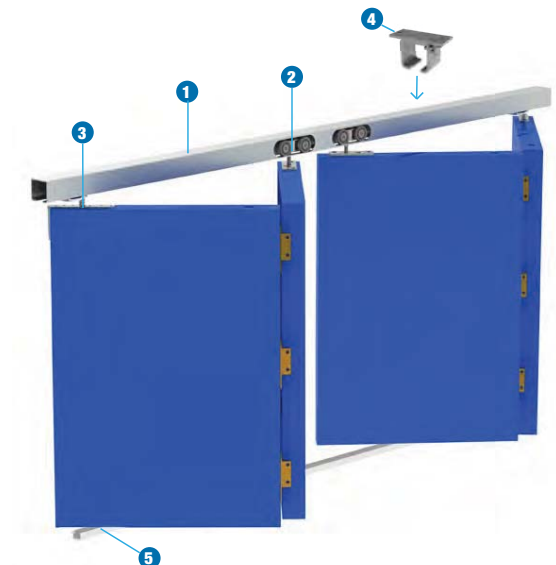



In series 100-500 there are two different types of folding doors: **Endfold** and **centrefold**. The series determines the maximum weight capacity per door, so by changing the track and the hangers you can easily increase the loading capacity from 30 kg up to 150 kg. These systems are available for both interior and exterior applications.

ENDFOLD SERIES (Door leaf weight 30-150 kg)

The endfold system uses a pivot set or hinges. In this system, the maximum width is limited because the weight is distributed only to the other end. The panels can fold to either one or both sides of the opening and can also be stacked behind a reveal if required. The endfold system folds only on the other side of the opening and that is why it is the most common and the most popular system.

With steel doors, the last hanger should be welded 25 mm or 30 mm (TPE-150 or TPE-300/500 hangers) from the end of the leaf.

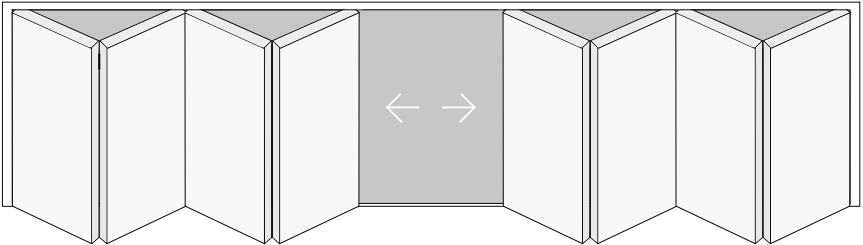

Endfold installation example. (● = Sliding hanger)

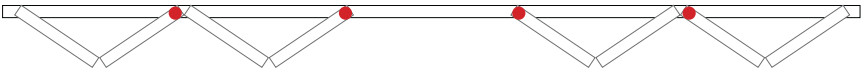

CENTREFOLD SERIES (Door leaf weight 30-150 kg)

The first panel is half-leaf, hinged to the post and the remaining leaves are full-size. The leaves are hung centrally under the lintel, and they fold to both sides of the opening.

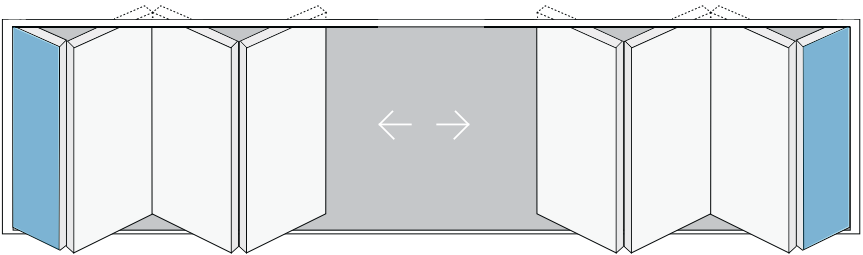

Centrefold installation example. (● = Sliding hanger)



SERIES 100-500

Folding door systems

Folding doors for industrial buildings and warehousing applications are a space-saving and economical solution. Thanks to their convenience and security, they are really popular solutions for **warehouses, garages, workshops and shipyards**.

Specifications

Weight <small>(max.)</small>	30-150 kg /door leaf
Door leaf thickness	25-66 mm
Door leaf size with endfold hanger <small>(max.)</small>	H 2750 - 4500 mm x W 900 - 1000 mm
Number of door leaves <small>(max.)</small>	8 pcs / side



SERIES 75
ENDFOLD

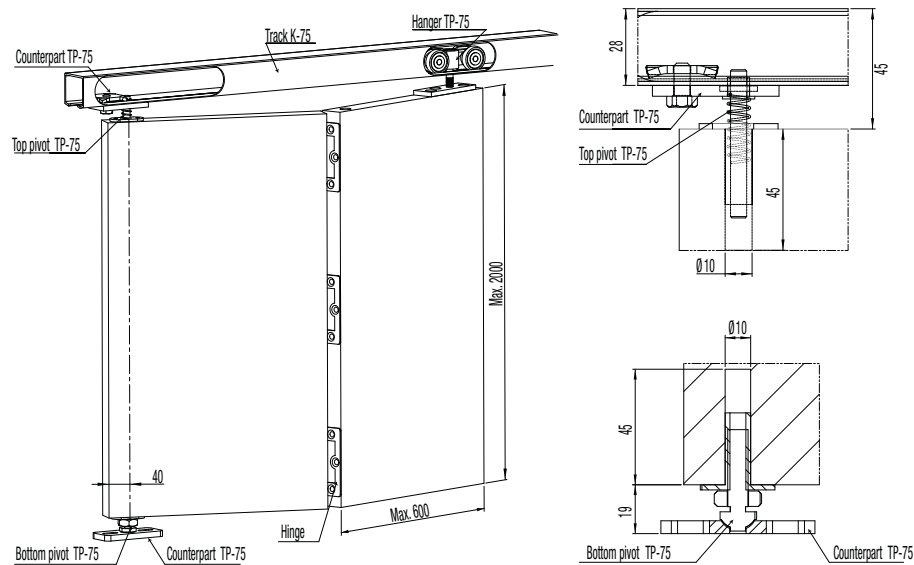

SERIES
100/150
CENTREFOLD

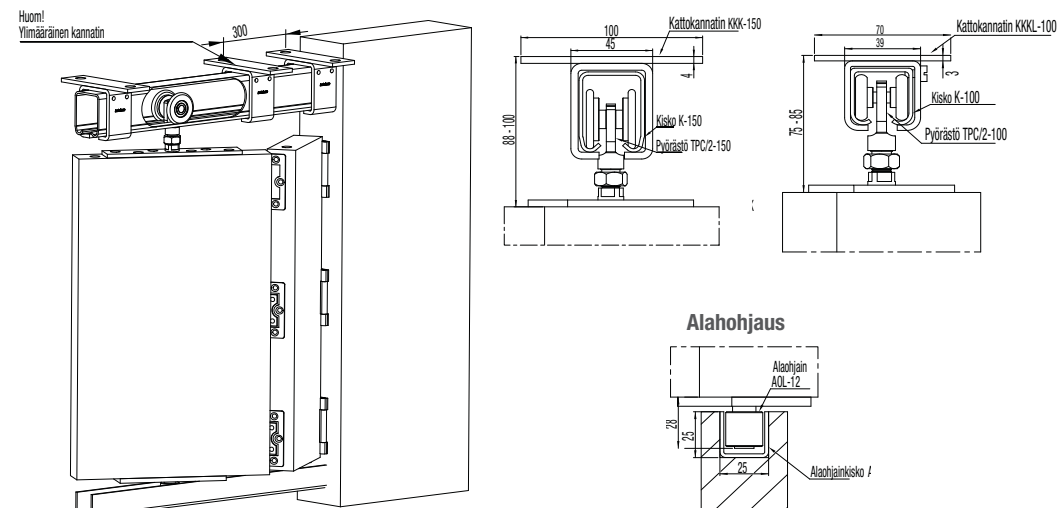

SERIES
100/150
ENDFOLD

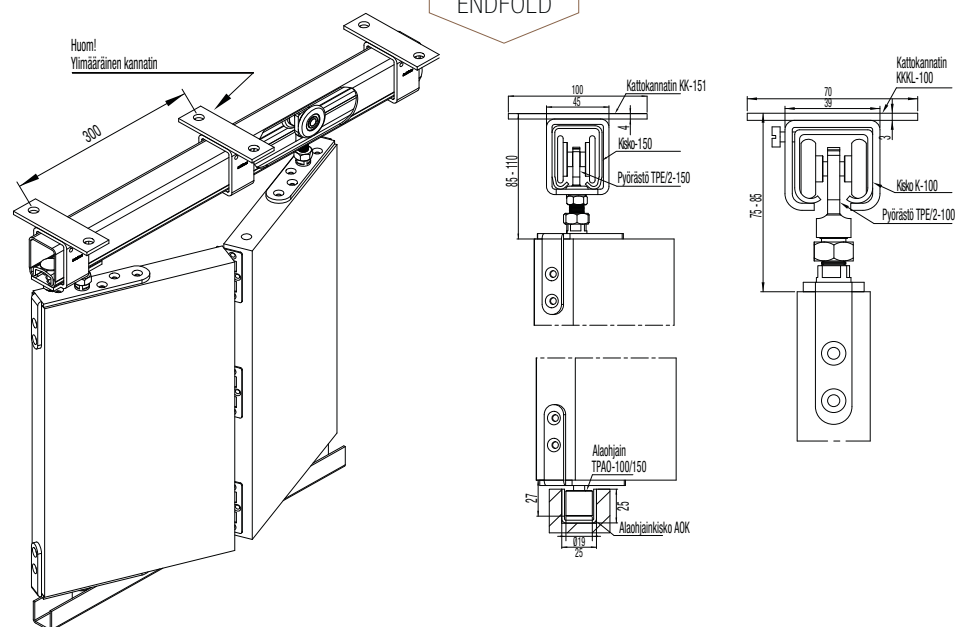

SERIES
300/500
CENTREFOLD

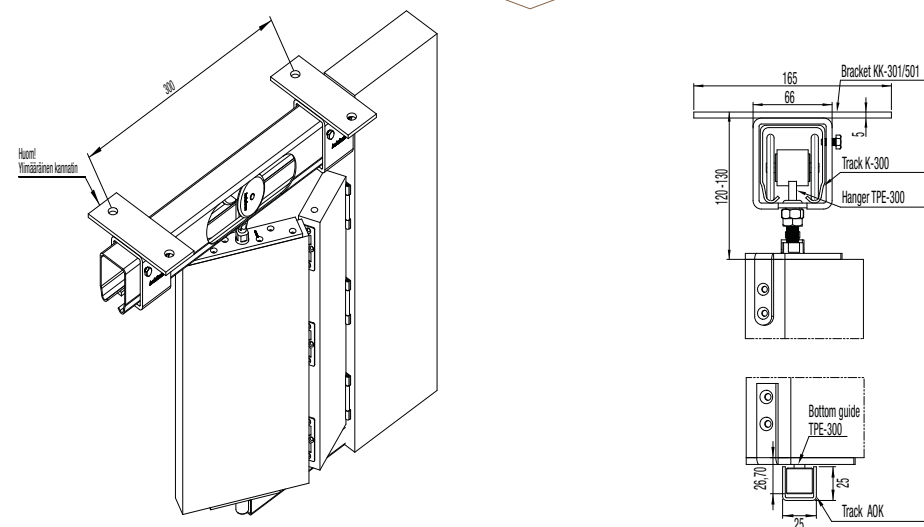

COMPLETE SETS

CODE



DIY Fittings set 902



1 x hanger
TP-75/nylon
(with plate)



3 x folding door hinge
TS-75



1 x top pivot
YH-75,
with counterpart



1 x bottom pivot
AH-75
with counterpart

20503



DIY Fittings set 904



2 x hanger
TP-75/nylon
(with plate)



6 x folding door hinge
TS-75



2 x top pivot
YH-75
with counterpart



2 x bottom pivot
AH-75
with counterpart

20504

SERIES 75

GALVANIZED STEEL TRACKS

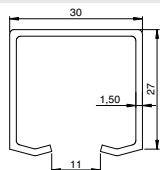

K-75 2 m

20001

K-75 2.4 m

20010

K-75 3 m

20003

K-75 4 m

20004

K-75 6 m

20006

ALUMINIUM TRACKS

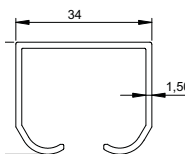

K-75 Junior 2 m (Al)

20017

K-75 Junior 2.4 m (Al)

20019

K-75 Junior 3 m (Al)

20020

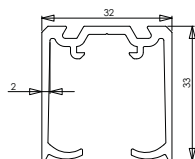

K-75 Flow 2,1 m (Al)

20201

K-75 Flow 2.4 m (Al)

20205

K-75 Flow 3 m (Al)

20203

K-75 Flow 4 m (Al)

20204

K-75 Flow 6 m (Al)

20206

ENDFOLD HANGER

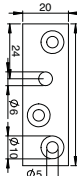
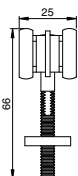
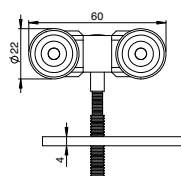

TP-75/nylon
With fixing plate.
For track K-75, K-75 Junior and
K-75 Flow.
(Capacity 25 kg / door leaf)

20059

SERIES 100

GALVANIZED STEEL TRACKS

CODE

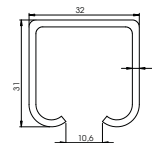

K-100 2 m

30017

K-100 3 m

30013

K-100 4 m

30014

K-100 6 m

30016

ENDFOLD HANGERS

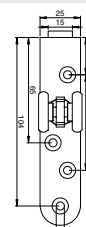
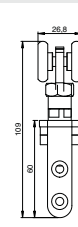
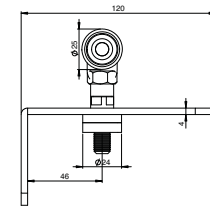

TPE/2-100/steel
For track K-100.
(Capacity 30 kg / door leaf)
Use with bottom guide
TPAO-100/150.

30045

TPE/2-100/nylon
For track K-100.
(Capacity 30 kg / door leaf)
Use with bottom guide
TPAO-100/150.

30046

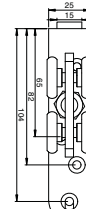
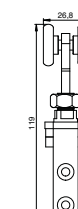
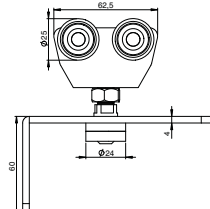

TPE/4-100/steel
For track K-100.
(Capacity 50 kg / door leaf)
Use with bottom guide
TPAO-100/150.

30049

TPE/4-100/nylon
For track K-100.
(Capacity 50 kg / door leaf)
Use with bottom guide
TPAO-100/150.

30050

CENTREFOLD HANGERS

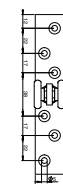
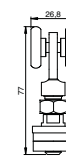
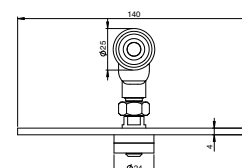

TPC/2-100/steel
For track K-100.
(Capacity 30 kg / door leaf)
Use with bottom guide
AOL-12.

30047

TPC/2-100/nylon
For track K-100.
(Capacity 30 kg / door leaf)
Use with bottom guide
AOL-12.

30048

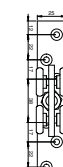
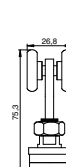
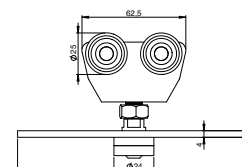

TPC/4-100/steel
For track K-100.
(Capacity 50 kg / door leaf)
Use with bottom guide
AOL-12.

30051

TPC/4-100/nylon
For track K-100.
(Capacity 50 kg / door leaf)
Use with bottom guide
AOL-12.

30052

SOFFIT BRACKET (Note! Wall brackets also available. Check page 75).

CODE

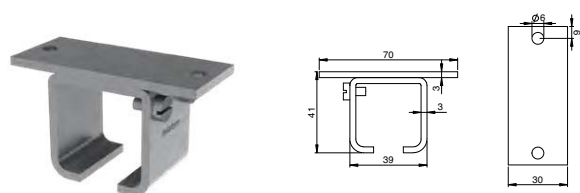

KKKL-100
Joint bracket.
For track K-100.

30080

SERIES 150

GALVANIZED STEEL TRACKS

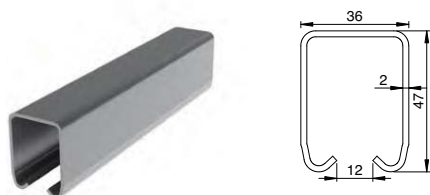

K-150 2 m	40012
K-150 3 m	40013
K-150 4 m	40014
K-150 5 m	40015
K-150 6 m	40016

ENDFOLD HANGERS

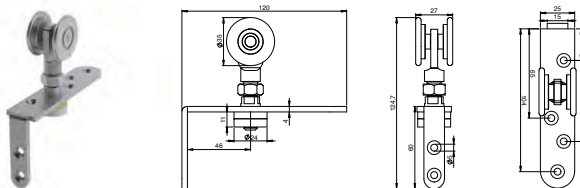

TPE/2-150/steel For track K-150. (Capacity 50 kg / door leaf) Use with bottom guide TPA0-100/150.	40036
TPE/2-150/nylon For track K-150. (Capacity 50 kg / door leaf) Use with bottom guide TPA0-100/150.	40039

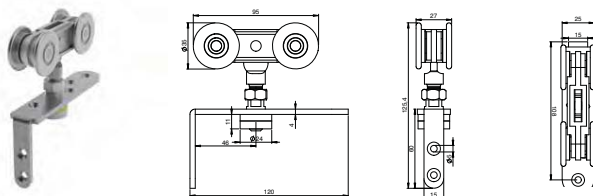

TPE/4-150/steel For track K-150. (Capacity 75 kg / door leaf) Use with bottom guide TPA0-100/150.	40038
TPE/4-150/nylon For track K-150. (Capacity 75 kg / door leaf) Use with bottom guide TPA0-100/150.	40032

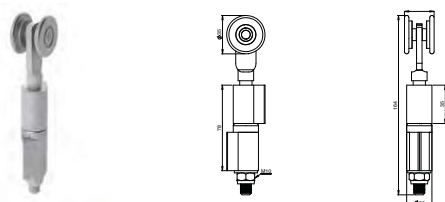

MTP/2-150/steel For metal folding doors. With welding hinges. For track K-150. (Capacity 50 kg / door leaf) Use with bottom guide MTA0-150/300/500.	40037
--	-------

ENDFOLD HANGERS

CODE

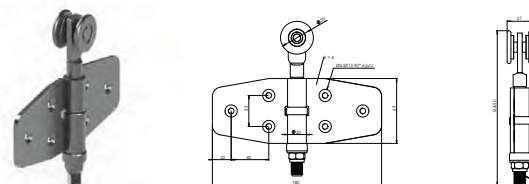

PTPE/2-150/steel
With butterfly hinges.
For track K-150.
(Capacity 50 kg / door leaf)
Use with bottom guide
PTA0-150/300/500.

40030

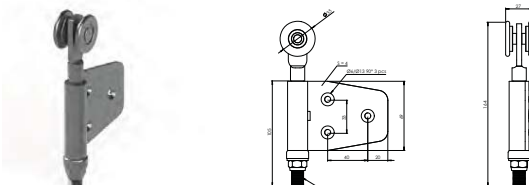

PTPE/2-150/steel, end leaf
With butterfly hinge.
For track K-150.
(Capacity 50 kg / door leaf)
Use with bottom guide
PTA0-150/300/500, end leaf.

40065

CENTREFOLD HANGERS

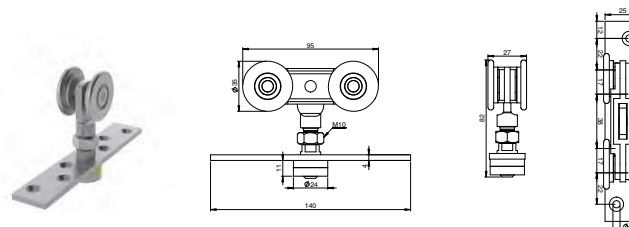

TPC/2-150/steel
For track K-150.
(Capacity 50 kg / door leaf)
Use with bottom guide
AOL-12.

40035

TPC/2-150/nylon
For track K-150.
(Capacity 50 kg / door leaf)
Use with bottom guide
AOL-12.

40034

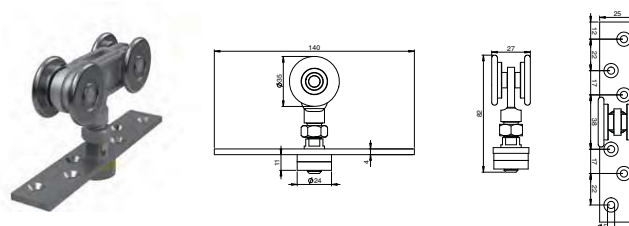

TPC/4-150/steel
For track K-150.
(Capacity 75 kg / door leaf)
Use with bottom guide
AOL-12.

40069

TPC/4-150/nylon
For track K-150.
(Capacity 75 kg / door leaf)
Use with bottom guide
AOL-12.

40031

SOFFIT BRACKETS (Note! Wall brackets also available. Check page 82).

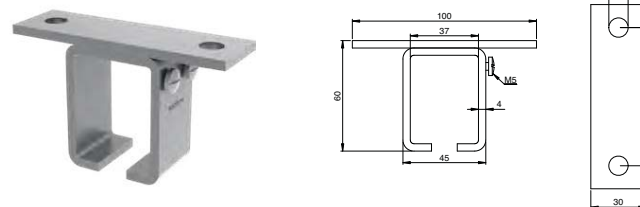

KKK-150
For track K-150.
Note! Without joint screws.

40084

KKKL-150
Joint bracket.
For track K-150.

40085

SERIES 300/500

GALVANIZED STEEL TRACKS

CODE

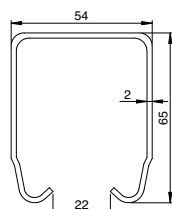

K-300 2 m	50012
K-300 3 m	50013
K-300 4 m	50014
K-300 5 m	50015
K-300 6 m	50016

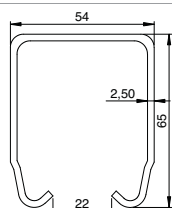

K-500 2 m	50022
K-500 3 m	50023
K-500 4 m	50024
K-500 5 m	50025
K-500 6 m	50026

ENDFOLD HANGERS

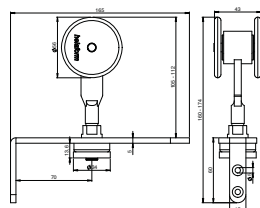

TPE/2-300/500/steel For tracks K-300 and K-500. (Capacity 75 kg / door leaf or 100 kg / door leaf) Used with bottom guide TPAO- 300/500	50061
---	-------

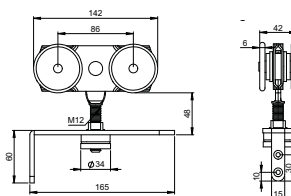

TPE/4-300/500/steel For tracks K-300 and K-500. (Capacity 100 kg / door leaf or 150 kg / door leaf) Used with bottom guide TPAO- 300/500	50062
--	-------

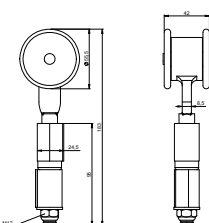

MTP/2-300/500 For metal folding door. With welding hinges. For tracks K-300 and K-500. (Capacity 75 kg / door leaf or 100 kg / door leaf) Use with bottom guide MTAO-150/300/500.	50046
---	-------

ENDFOLD HANGERS

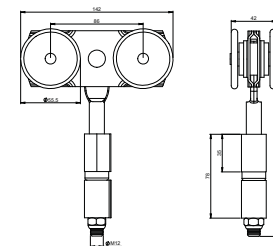

MTP/4-300/500/steel For metal folding door. With welding hinges. For tracks K-300 and K-500. (Capacity 100 kg / door leaf or 150 kg / door leaf) Use with bottom guide MTAO-150/300/500.	50047
--	-------

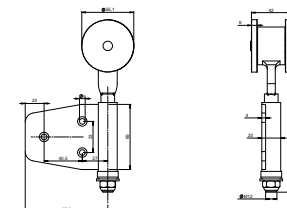

PTPE/2-300/500/steel, end leaf With butterfly hinge. For tracks K-300 and K-500. (Capacity 75 kg / door leaf or 100 kg / door leaf) Use with bottom guide PTAO-150/300/500, end leaf.	50039
--	-------

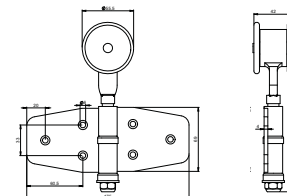

PTPE/2-300/500/steel With butterfly hinges. For tracks K-300 and K-500. (Capacity 75 kg / door leaf or 100 kg / door leaf) Use with bottom guide PTAO-150/300/500.	50048
---	-------

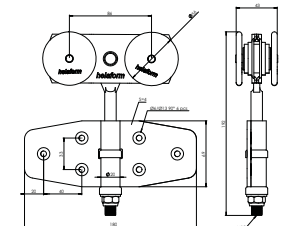

PTPE/4-300/500/steel With butterfly hinges. For tracks K-300 and K-500. (Capacity 100 kg / door leaf or 150 kg / door leaf) Use with bottom guide PTAO-150/300/500.	50038
--	-------

CENTREFOLD HANGERS

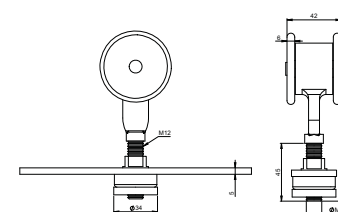

TPC/2-300/500/steel For tracks K-300 and K-500. (Capacity 75 kg / door leaf or 100 kg / door leaf) Use with bottom guide AOL-12.	50059
--	-------

CENTREFOLD HANGERS	CODE
--------------------	------

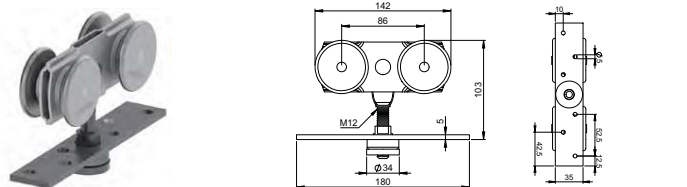

TPC/4-300/500/steel
For tracks K-300 and K-500.
(Capacity 100 kg / door leaf or
150 kg / door leaf)
Use with bottom guide
AQL-12.

CODE

50065

SOFFIT BRACKETS (Note! Wall brackets also available. Check page 90).

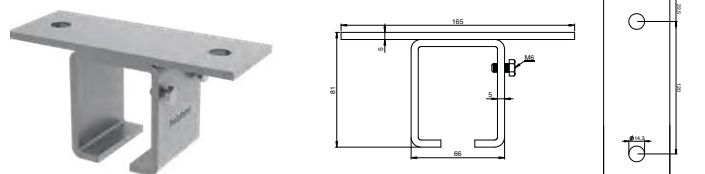

KKK-300/500 For tracks K-300 and K-500. <i>Note! Without joint screws.</i>	50084
---	-------

50084

KKKL-300/500 Joint bracket. For tracks K-300 and K-500.	50085
--	-------

50085

BOTTOM GUIDES AND ACCESSORIES (FOR SERIES 100 - 500)

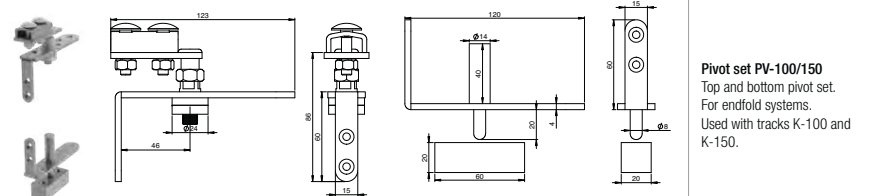

Pivot set PV-100/150 Top and bottom pivot set. For endfold systems. Used with tracks K-100 and K-150.	40106
--	-------

40106

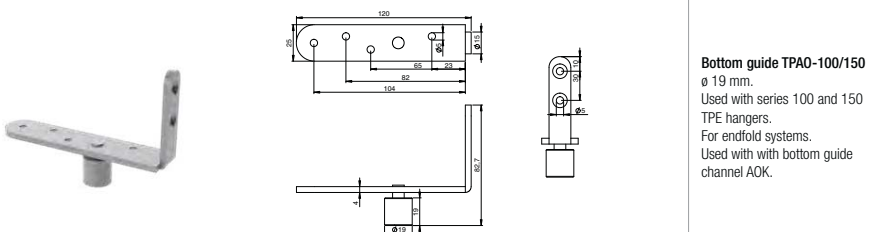

Bottom guide TPAO-100/150
 ø 19 mm.
 Used with series 100 and 150
 TPE hangers.
 For endfold systems.
 Used with with bottom guide
 channel AOK.

50336

50336

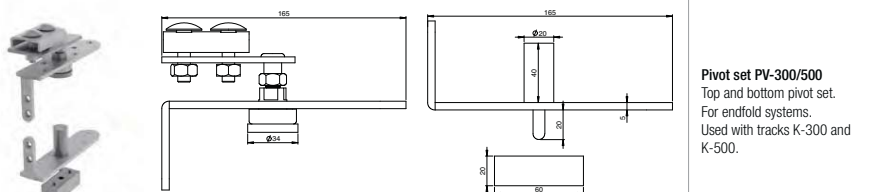

Pivot set PV-300/500 Top and bottom pivot set. For endfold systems. Used with tracks K-300 and K-500.	50106
--	-------

50106

BOTTOM GUIDES AND ACCESSORIES (FOR SERIES 100-500)		CODE
--	--	------

CODE

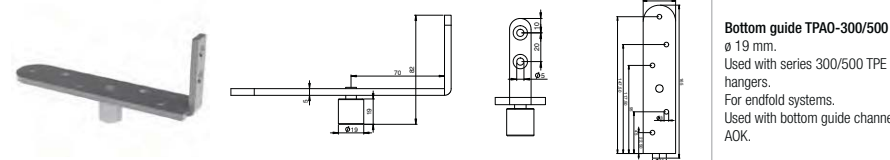

<p>Bottom guide TPAO-300/500 ø 19 mm. Used with series 300/500 TPE hangers. For endfold systems. Used with bottom guide channel AOK</p>	<p>50337</p>
--	--------------

50337

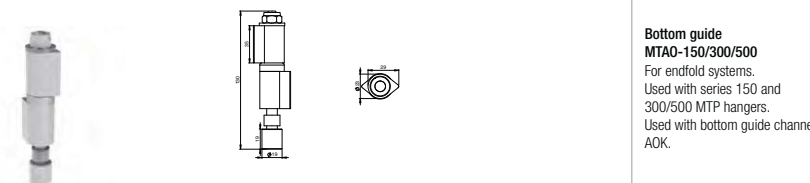

Bottom guide MTAO-150/300/500 For endfold systems. Used with series 150 and 300/500 MTP hangers. Used with bottom guide channel AOK.	50338
--	-------

50338

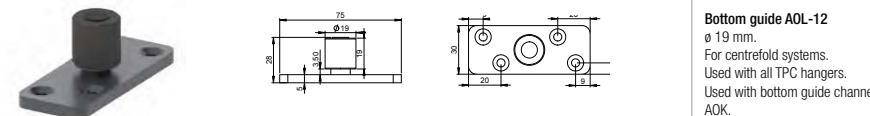

Bottom guide AOL-12 ø 19 mm. For centrefold systems. Used with all TPC hangers. Used with bottom guide channel AOK	50335
--	-------

50335

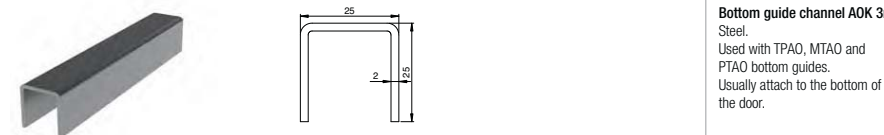

<p>Bottom guide channel AOK 3m Steel. Used with TPAO, MTAO and PTAO bottom guides. Usually attach to the bottom of the door.</p>	50318
---	-------

50318

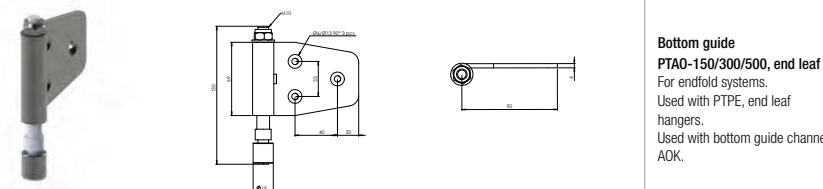

Bottom guide PTAO-150/300/500, end leaf For endfold systems. Used with PTPE, end leaf hangers. Used with bottom guide channel AOK.	50327
--	-------

50327

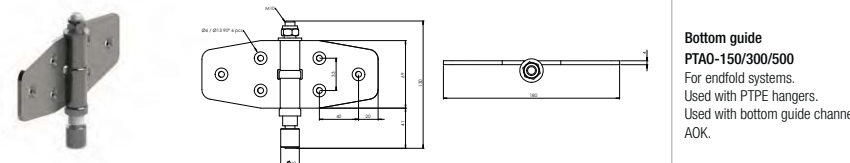

Bottom guide PTAO-150/300/500 For endfold systems. Used with PTPe hangers. Used with bottom guide channel AOK.	50328
---	-------

50328

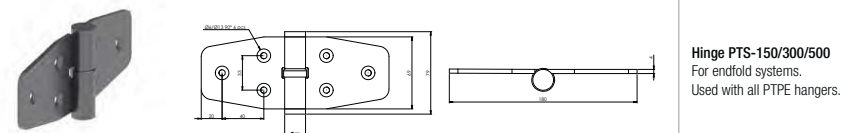

Hinge PTS-150/300/500 For endfold systems. Used with all PTPE hangers.	50404
---	-------

50404